

# MAKS WDC mini

WIRELESS MAGNETIC CONTACT SENSOR

# MAKS

- available in three colors
- secure two-way radio communication with MAKS PRO
- 868,0 ... 868.6MHz, several channels for redundancy, range up to 2000 m
- power - lithium battery CR2, up to 5 years of operation
- easy and fast installation
- secure fastening
- efficient on metal doors
- miniature sensor



Security point magnetic contact radio channel detector (sensor) is designed to monitor the status of structural elements (open/move) in order to detect an attempt to enter the room. The device sends an alarm notification to the alarm center MAKS PRO security alarm system.

Mounted indoors and used to protect doors and windows.

## Radio communication

The detector transceiver operates in several channels of 868.0 ... 868.6 MHz band for redundancy.

Secure two-way radio communication.

Distance - up to 2000 m in the open space.

Three grades of power, maximum - up to 20 mW.

## Setting up

The detector operates only with the MAKS PRO wireless security system center, connection to other systems is not provided.

The sensor is connected to the security center and

is configured using the MAKS Setup mobile application.



## Batteries

The device uses an CR2 battery (included)

## Characteristics

Reed switch threshold	7-15 mm
Maximum number of actuations	not less than 1,000,000
ISM wireless interface, up to 2000 m	868,0... 868,6 MHz
Power (lithium battery included)	CR2 battery 3V
standby consumption	no more than 2 $\mu$ A
transmission consumption	up to 45 mA
service life of battery	5 years
Electromagnetic field immunity	8 V/m
Operating temperature range	-20°C to +50°C
Case color	white, dark brown, black
Detector dimensions	85 x 18,5 x 17,6 mm
Magnet dimensions	85 x 11 x 6 mm
Weight	56 grams

For more information on setting up and operating the device, please visit [www.maks.systems](http://www.maks.systems)

## Functional parts of the device

1. Bottom plate of magnet case
2. Magnet case cover
3. Neodymium magnet
4. Bottom plate of the detector case
5. Detector case top cover and capsule with the device
6. Magnet position marks
7. LED indicator
8. Tamper contact
9. On/off button
10. Battery CR2

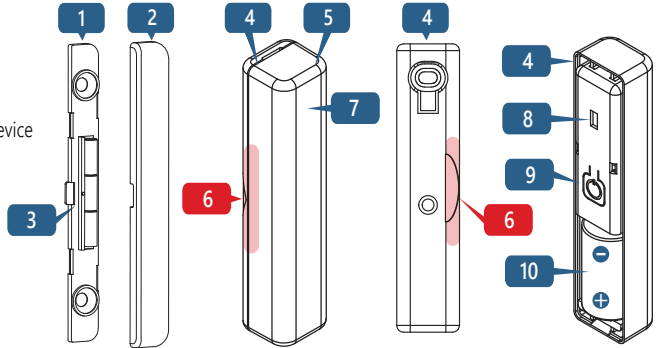

## Installation and connection

### Registration and setup

1. Place the detector at a distance of no more than 2 m from the MAKS PRO security center. The registration runs at the lowest possible power to avoid the influence of neighboring systems which can be being set up nearby.
2. Start the MAKS Setup application
3. Follow the instructions of the application to connect to the MAKS PRO and start the registration of MAKS wireless devices
4. Turn on the MAKS WDC mini, after 10-20 seconds it will be registered
5. Set up a new device in your mobile application

*The sensor can be placed vertically or horizontally. Install magnet near mark 6 on the detector case.*

### We recommend to install the device in the following order:

1. Selecting the installation location with the best signal using the MAKS Setup application
2. Mounting the magnet (step 1)
3. Installation of the detector bottom plate (step 2),
4. Installation of the device (step 3)

*When the capsule is inserted correctly, the tamper must be clamped (locked).*

### Switching on and off

Press button **9** to turn on the device - the indicator will be on. If the device is registered in the MAKS PRO, it switches to standby mode. If the sensor is not registered, it will switch to sleep mode after 30 seconds.

To turn off the device, press and hold button **9** for 5 seconds.

### Selecting the installation location

Carefully select the installation location of the MAKS WDC mini detector.

The device should not be placed:

1. Outdoors or in areas with unacceptable humidity and temperature
2. In places with a high level of radio interference
3. Near objects that can cause radio signal attenuation or shielding (metal, mirrors, etc.)
4. At a distance of less than 1 m from the security center

### Indication in communication test mode

**Excellent connection** - LED indicator flashes green

**Satisfactory connection** - LED indicator flashes yellow

**Poor connection** - LED indicator flashes red

**No connection** - LED indicator flashes red quickly

*In test mode, the unit's radio transmitter operates at medium power.*

