

- miniature siren for indoor use
- elegant design
- available in two colors
- sound pressure level - 85 dB at a distance of 1 m
- arming confirmation indicator connection
- 868,0 ... 868.6MHz, several channels for redundancy, range up to 2000 m
- power supply - two CR123A batteries
- up to five years of service
- easy and fast installation



This wireless siren is designed for alarm notification when the wireless detectors of MAKS PRO security center are triggered. It is installed indoors to warn about the danger or scare off intruders. The device has contacts for connecting the arming information LED and external reed switch.

## Radio communication

The siren transceiver operates in several channels of 868.0 ... 868.6 MHz band for redundancy  
Secure two-way radio communication.  
Distance - up to 2000 m in the open space.  
Three gradations of power, the maximum - up to 20 mW.

## Setting up

The siren operates only with the MAKS PRO wireless security system center, connection to other systems is not provided.  
The siren is connected to the security center and configured using the MAKS Setup mobile application. The volume and running time of the audible alarm are adjustable.



## Features

The time for switching on the built-in indicator or external arming information LED is 15 seconds.  
For "Armed" status indication, you can set the built-in indicator or external LED to flash once every 10 seconds.  
If MAKS PRO is in the "Armed (Stay)" mode, the alarm sound will always be activated at the minimum volume.  
In the event of an alarm, the MAKS wireless siren will be activated no later than in 10 seconds (communication period with the security center).

## Characteristics

ISM wireless interface, up to 2000 m	868.0... 868.6 MHz
secure two-way communication	key - 256 bits
Power (lithium batteries included)	two CR123A, 3V batteries
consumption in standby mode	no more than 5 $\mu$ A
radio consumption	no more than 35 $\mu$ A
alarm consumption	no more than 70 $\mu$ A
service life of battery	up to 5 years
Sound pressure level at 1 m	at least 85 dB
Operating temperature range	from -10°C to +55°C
Case color	white, black
Dimensions	84.5 x 84.5 x 24.3 mm
Weight	134 g
Connection to MAKS Siren	external LED and reed switch
distance (cable length) to external elements	no more than 1.5 m
Volume levels, adjustable	3
Light indication, adjustable	built-in or external indicator

For more information on setting up and operating the device, please visit [www.maks.systems](http://www.maks.systems)

## Functional parts of the device

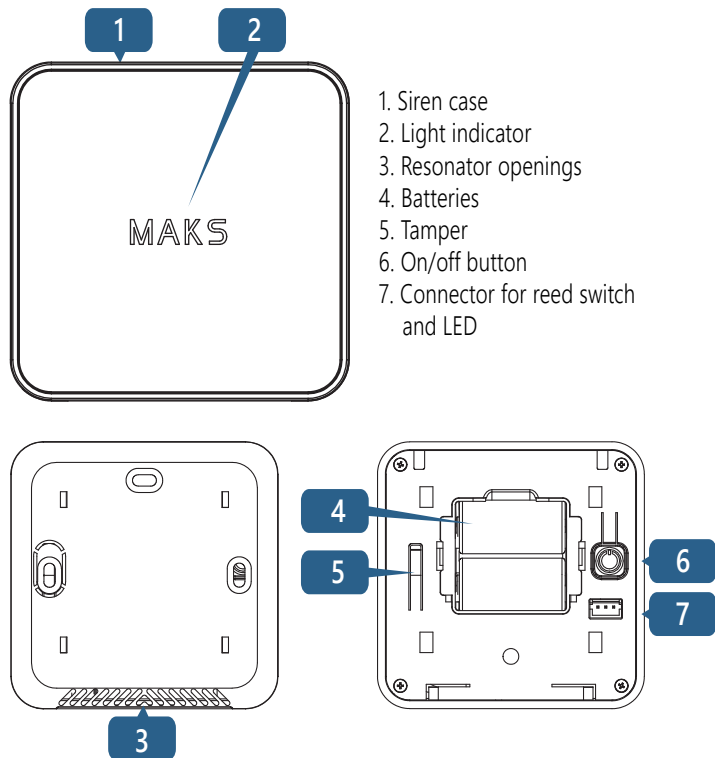

## Indication

**Sleep mode** - indicator off

**Alarm mode** - light indicator flashes red, the alarm sounds

**Arming mode confirmation** - short beep. Turn on the external LED or the built-in indicator for 15 seconds (if configured)

**Arming mode** - flashing of the external LED or built-in indicator every 10 seconds (if configured)

**Disarming confirmation** - two short beeps

## Display in communication test mode

**Excellent connection** - LED indicator flashes green

**Satisfactory connection** - LED indicator flashes yellow

**Poor connection** - LED indicator flashes red

**No connection** - LED indicator flashes red quickly

*In test mode, the unit's radio transmitter operates at medium power.*

## Switching on and off

Press button **6** to switch on the device - the indicator will be on and you will hear a sound signal.

To turn off the device, press and hold button **6** for 3 seconds, until the light indication goes out.

## Registration and setup

1. Place the siren at a distance of no more than 2 m from the MAKS PRO security center. Registration is run at a minimal possible power to avoid the influence of neighboring systems that can be being configured nearby.

2. Start the MAKS SETUP application

3. Follow the application instructions to connect to the MAKS Siren and start the registration of MAKS wireless devices

4. Turn on the MAKS PIR, after 10-20 seconds it will be registered

5. Set up a new device in your mobile application

## Installation and connection

Before installing the MAKS Siren, register it in the MAKS PRO and test the siren signal level using the MAKS Setup app.

We recommend to install the device in the following order:

1. Selecting the installation location with the best signal
2. Mounting the rear plate (mount)
3. Siren installation

## Selecting the installation location

Carefully select the installation location of the MAKS Siren.

The device should not be placed:

1. Outdoors or in areas with unacceptable humidity and temperature
2. In places with a high level of radio interference
3. Near objects that can cause radio signal attenuation or shielding (metal, mirrors, etc.)
4. At a distance of less than 1 m from the security center

## Device installation

1. Use a plastic card to remove the device from the plate
2. Insert the card into the slot
3. Press the fixation elements down with the card
4. Move the siren upwards
5. Remove the MAKS Siren from the mount
6. Fit the mount using the screws and wall plugs provided.
7. Place the siren on the bracket and slide it down to fix the bottom and top parts and lock the tamper contact **5**. Flashes on indicator **2** will confirm that the tamper is locked in place.

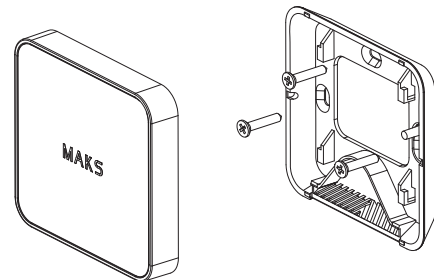
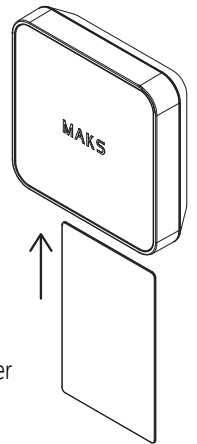

## Battery replacement

1. Use a plastic card to remove the device from the mount
2. Pull out and replace the batteries
3. Place the siren on the bracket and slide it down until it locks

## Connecting the reed switch and LED

Connect the reed switch and LED to the connector terminals as shown.

9. LD contact (+ LED)
10. GND contact (earth)
11. DC contact (reed switch)
12. LED (LED)
13. Reed switch

